

Bethel Missionary Baptist Church

Rev. Dr. R.B. Holmes, Jr., Pastor

MOBILE MEDICAL UNIT

Matthew: 9:35-38 (KJV)

³⁵And Jesus went about all the cities and villages, teaching in their synagogues, and preaching the gospel of the kingdom, and healing every sickness and every disease among the people.

³⁶But when he saw the multitudes, he was moved with compassion on them, because they fainted, and were scattered abroad, as sheep having no shepherd.

³⁷Then saith he unto his disciples, **The harvest truly is plenteous, but the labourers are few;**

³⁸ **Pray ye therefore the Lord of the harvest, that he will send forth labourers into his harvest.**

BETHEL MISSIONARY BAPTIST CHURCH HEALTHCARE MINISTRY

- HISTORICALLY SPEAKING...

The ministry began when a group of health professionals purchased two first aid kits and a blood pressure cuff to monitor blood pressures of the church membership on a monthly basis. A clinic table was donated to the ministry for screenings as well as a wheelchair to provide necessary equipment for those who had a need while attending church. Today, the ministry is composed of Physicians, Nurse Practitioners, Nurses, Pharmacists, Physical and Occupational Therapists, Health Educators, Health Support Aides and other Health Related Professionals. Membership in the ministry is not exclusive to just health professionals, therefore, any member of the congregation who wishes to serve the Lord in a healthcare capacity is welcome to join.

- *Ministry Objectives:*

- *a) provide health information (through health promotion, health education, risk reduction methods, and disease prevention methods)*
- *b) provide assistance to the congregation (through health screenings, referrals, telephone calls, training and in-services),*
- *c) provide assistance to the community at large (through health fairs, seminars, donations, walk-a-thons, and referrals).*

HEALTHCARE MINISTRY THEME SCRIPTURE:

What? know ye not that your body is the temple of the Holy Ghost which is in you, which ye have of God, and ye are not your own? For ye are bought with a price: therefore glorify God in your body, and in your spirit, which are God's.

1 Corinthians 6:19-20 (KJV)

A CALL TO COMPASSION

VISION 2030...

BETHEL MISSIONARY BAPTIST CHURCH
Reverend Dr. RB Holmes, Pastor



Vision
2030



BELIEVE **B** UNITE **U** INTEGRITY **I** LEADERSHIP **L** DELIVERENCE **D**

for the *GLORY* of Jesus Christ!

1. **BUILD** a new *Bethel Missionary Baptist Church and campus.*
2. **BUILD** the Bethel land inventory to **40+ acres.**
3. **BUILD** a stronger *Evangelism and Christian Education Ministry and Movement.*
4. **BUILD** stronger *Stewardship, Mission and Outreach Ministries.*
5. **BUILD** stronger *Family-Based Ministries: Couples, Singles, Blended Families, Parenting, Men, Women, Retirees.*
6. **BUILD** stronger *Millennial and Collegiate Ministries.*
7. **BUILD** stronger *Youth and Children Ministries.*
8. **BUILD** a stronger *Economic Entrepreneurship Ministry.* Transition Frenchtown and surrounding areas with strong economic vibrancy embedded within a stronger social justice infrastructure.
9. **BUILD** stronger *Heath Care, Mental Health, Wellness and Fitness Ministries.*
10. **BUILD** stronger *Music and Media Ministries.*
11. **BUILD** Bethel's *financial capital, collateral, and capacity* to 50 million + dollars. Encourage members to include Bethel in their wills, estates and endowments.
12. **BUILD** a *Holistic Retirement Campus* for Baby Boomers, Generation X, and



Thematic Scriptures:

- Joshua 3:1-8
- Nehemiah 3:17-20; 4:10
- Psalms 122:1-9
- Malachi 3:6-12
- St Matthew 6:32-34; 16:13-19; 28:18-20
- Acts 1:1-8
- Ephesians 4:1-13
- Revelation 22:1-20

Thematic Hymns:

- *Stand for Something*
- *A Charge to Keep I Have*
- *The Solid Rock*
- *Break Every Chain*



MOBILE MEDICAL UNIT

- **STATE OF THE ART:
TWO EXAM ROOM, LAB & WAITING
ROOM MOBILE CLINIC**

MOBILE MEDICAL UNIT

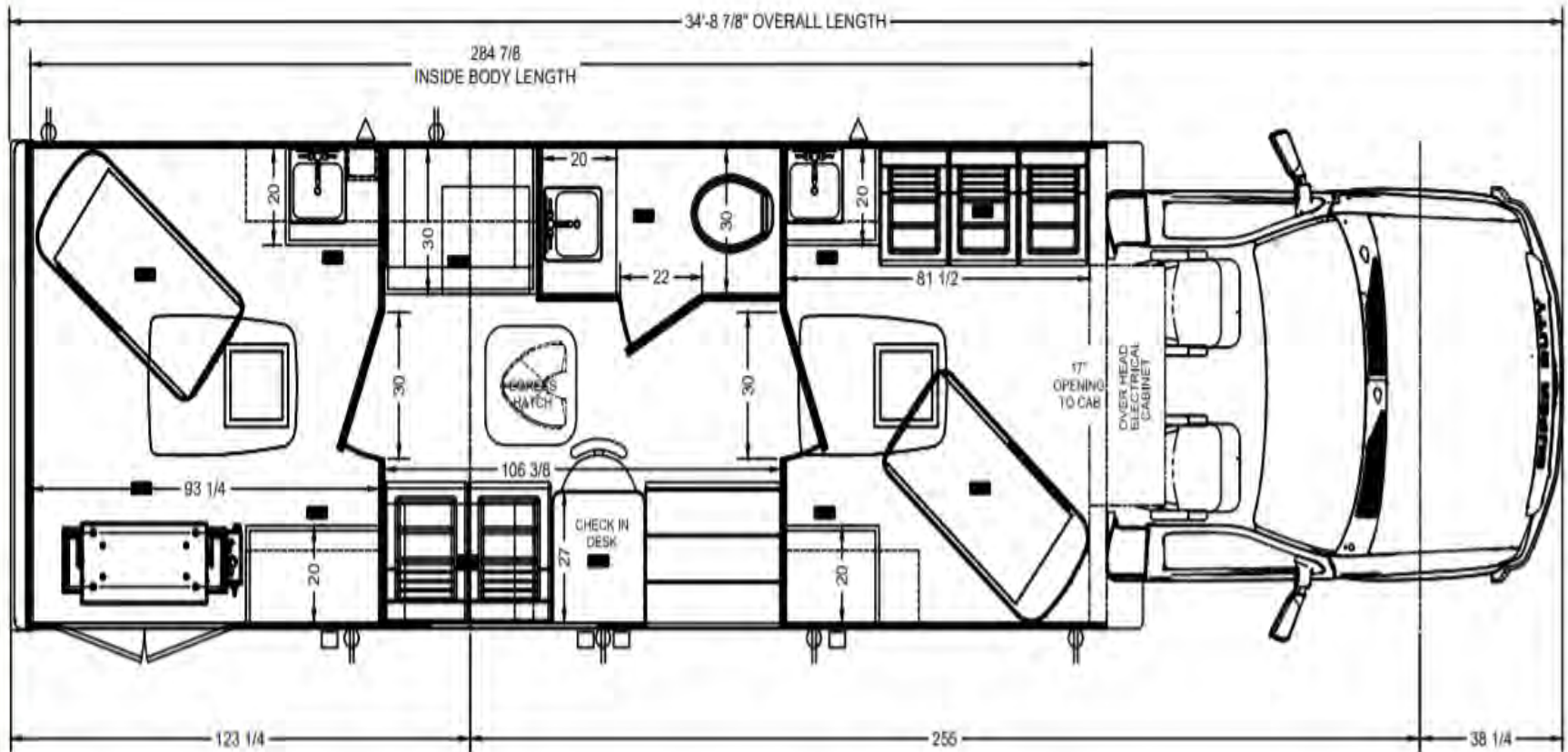

MOBILE MEDICAL UNIT



MOBILE MEDICAL UNIT

VIEWS OF THE WAITING AREA & CHECK-IN DESK



MOBILE MEDICAL UNIT

VIEWS OF THE RESTROOM



MOBILE MEDICAL UNIT

VIEWS OF THE
HANDICAP
ACCESSIBLE EXAM
ROOM



MOBILE MEDICAL UNIT

**VIEWS OF THE
HANDICAP
ACCESSIBLE EXAM
ROOM**



MOBILE MEDICAL UNIT

VIEWS OF THE EXAM ROOM 2



MOBILE MEDICAL UNIT

VIEW OF THE
STORAGE AREA



PROPOSED SERVICES TO PROVIDE

Primary Care Services

Vaccinations
(COVID-19)

Blood
Pressure
Assessments

Weight &
BMI
Assessments

Glucose
Assessments

Basic
Physical
Exams

• +/-Lab work